

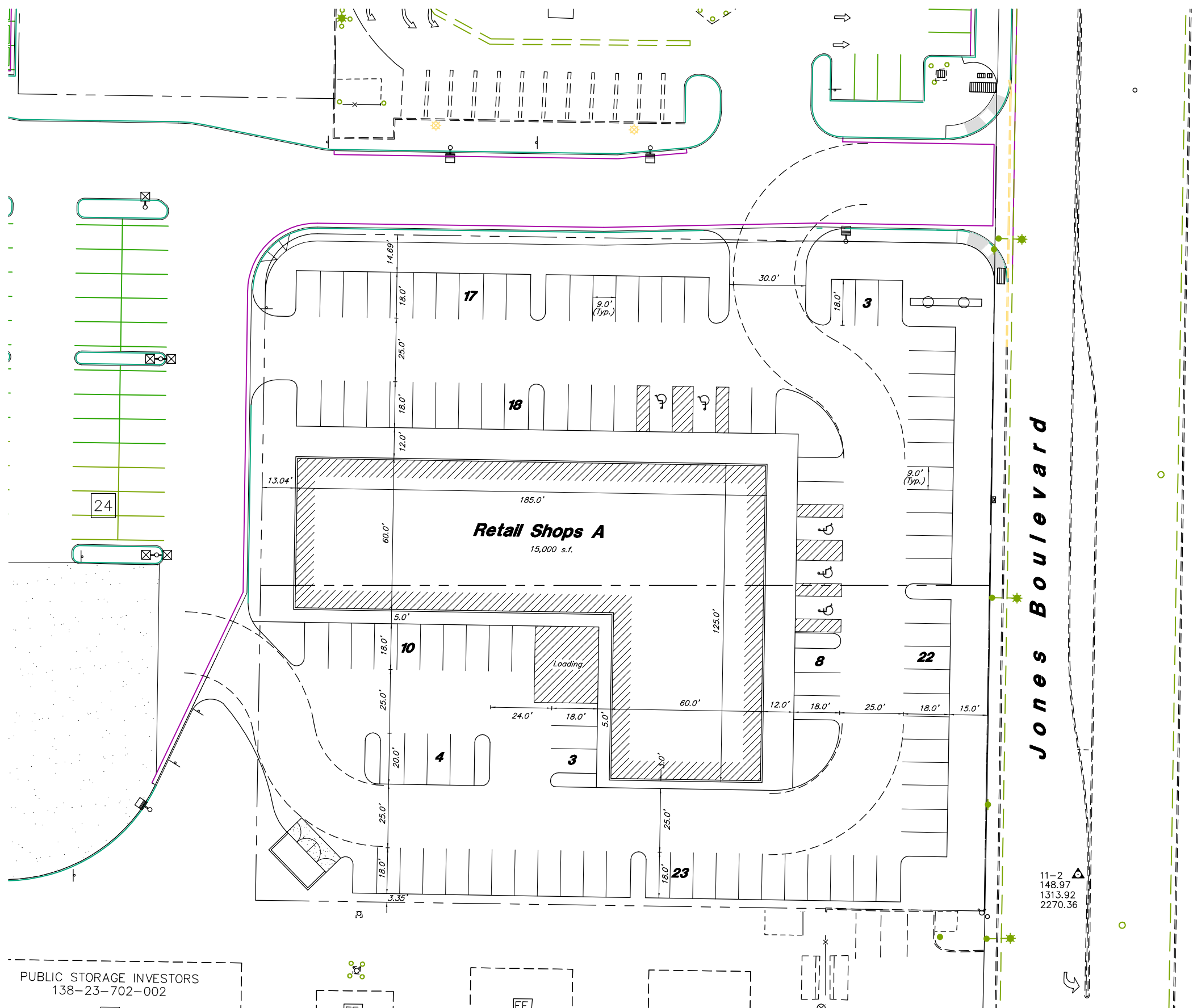

Scale : 1" = 20'



Jones Boulevard

CROSSINGS AT LAKE MEAD
138-24-301-004
CLV #

Site Area = 74,819 s.f. (1.718 ac.)
Building Area = 15,000 s.f. (20%)
Parking Provided = 108 stalls (7.2/1000)

11-2
148.97
1313.92
2270.36

PUBLIC STORAGE INVESTORS
138-23-702-002